

FOWLER CREEK GUEST RANCH
EXHIBIT 12
EMERGENCY INGRESS AND EGRESS PLAN

The proposed Fowler Creek Guest Ranch is designed to meet the rigorous standards of the Kittitas County Code and the International Fire Code Appendix D. Beyond mere compliance, the internal road system of the guest ranch has been thoughtfully crafted to enhance safety, minimize congestion, and facilitate swift evacuation during both routine traffic and emergency scenarios.

Key Features of Emergency Ingress and Egress Plan:

1. **Loop Road Design:** The internal road system incorporates a well-defined loop, ensuring efficient traffic flow and reducing bottlenecks. This strategic layout allows for smooth movement even during peak traffic times and emergencies.
2. **Cul-de-Sacs for Emergency Gathering:** Two strategically placed cul-de-sacs within the road loop serve as designated emergency gathering points. These areas provide safe assembly locations for guests and staff during critical situations.
3. **Bidirectional Emergency Escape Routes:** Our road network offers bidirectional escape routes, allowing rapid evacuation in any direction. Safety is paramount, and these routes are meticulously maintained and clearly marked.
4. **Additional Turnaround:** During construction, a turnaround area for emergency vehicles will be established in the southwest corner of the guest ranch. This will provide extra space for additional maneuvering during emergency situations.
5. **Primary Exits:**
 - **Fowler Creek Road Exit:** The primary exit connects directly to Fowler Creek Road, ensuring swift access to external routes.
 - **Gated Emergency Exit onto Forest Service Road 4517:** Located at the southwest end of the proposed guest ranch, this gated exit serves as a crucial two-way emergency route. In the event that Forest Service Road 4517 becomes obstructed during an emergency, the main road within the guest ranch provides an alternative path for bypassing any potential blockage as it leads those in the southwest corner to Fowler Creek Road.

PROPOSED EMERGENCY INGRESS & EGRESS PLAN MAP - FOWLER CREEK GUEST RANCH

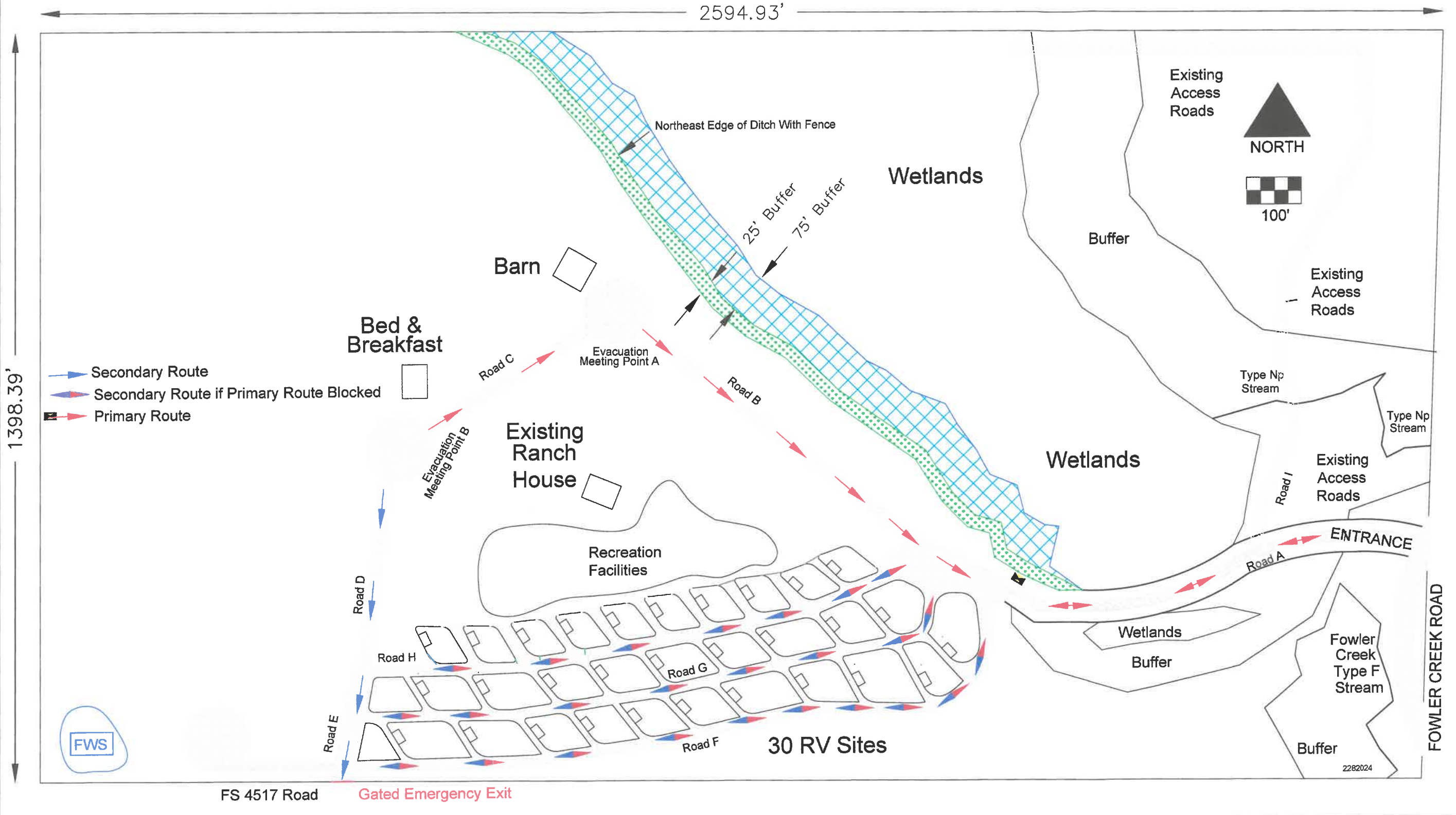

PROPOSED EMERGENCY F.S. Road 4517 BYPASS - FOWLER CREEK GUEST RANCH

